

AMOUNT	DESIGNATION	POS.	MATERIAL	WEIGHT/ AMOUNT	NORM	REMARK
1	welding group "L1"	L1	1.0038	144kg		see: 49-1300.02
1	welding group "L2"	L2	1.0038	184kg		see: 49-1300.03

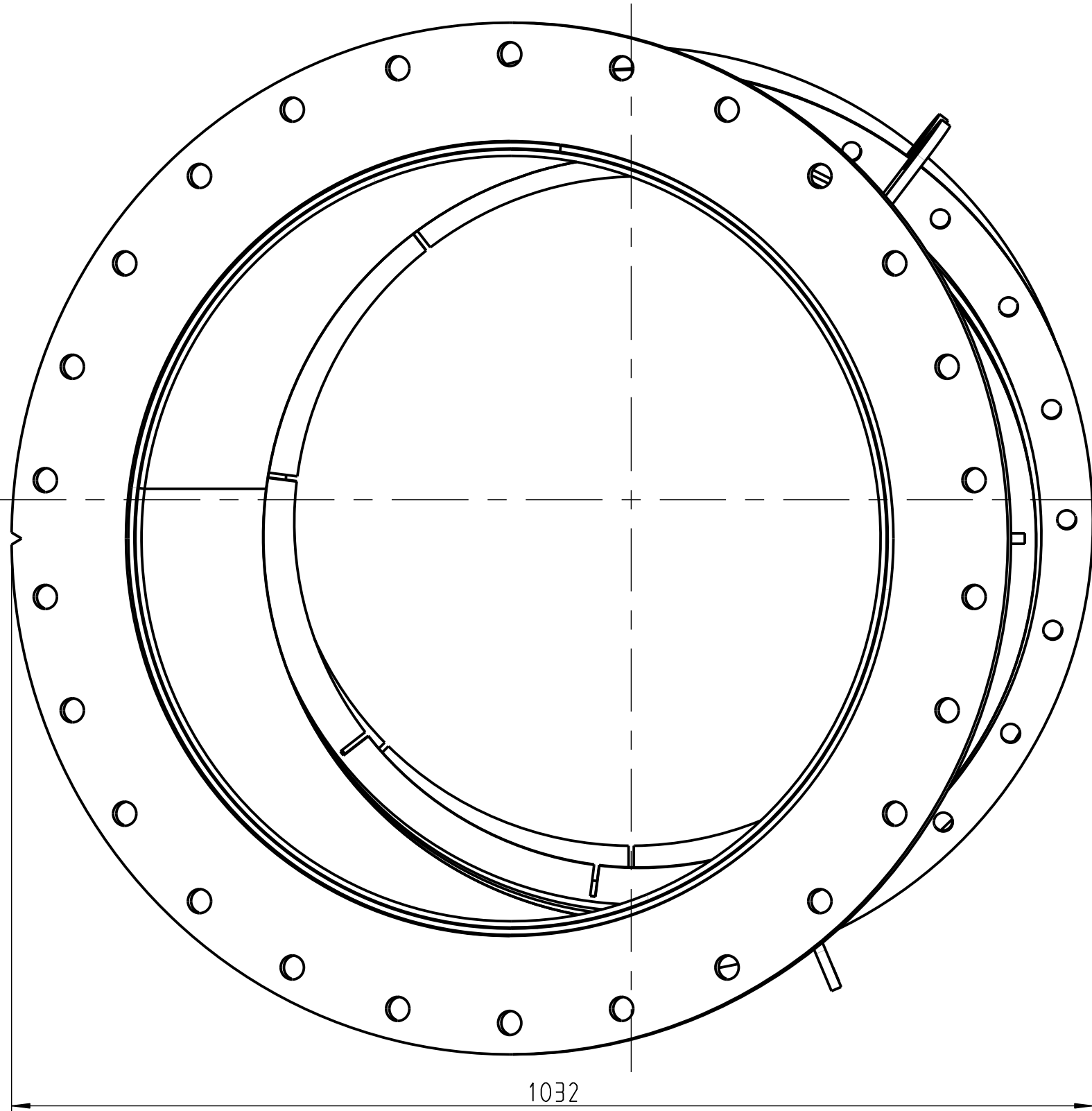
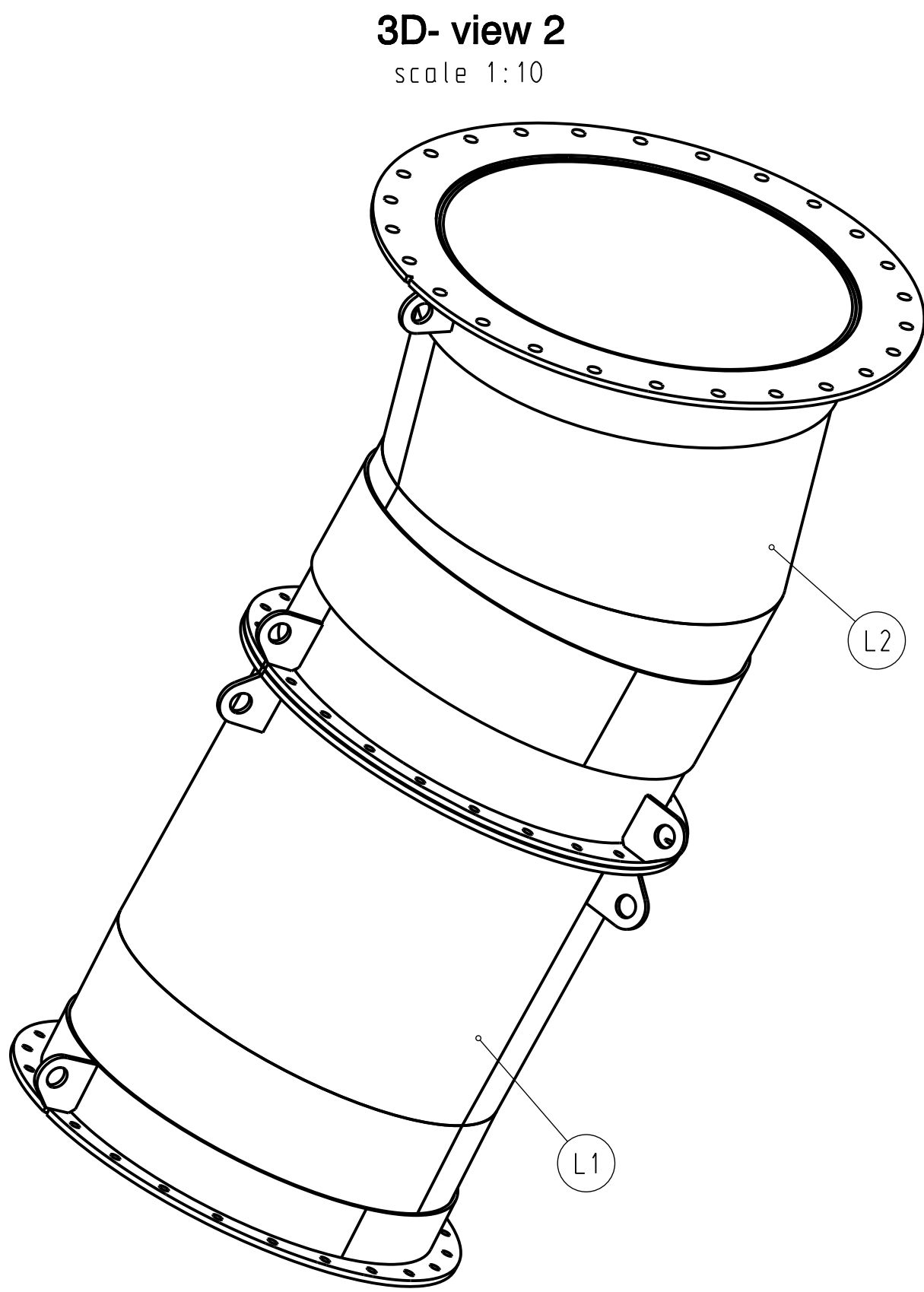
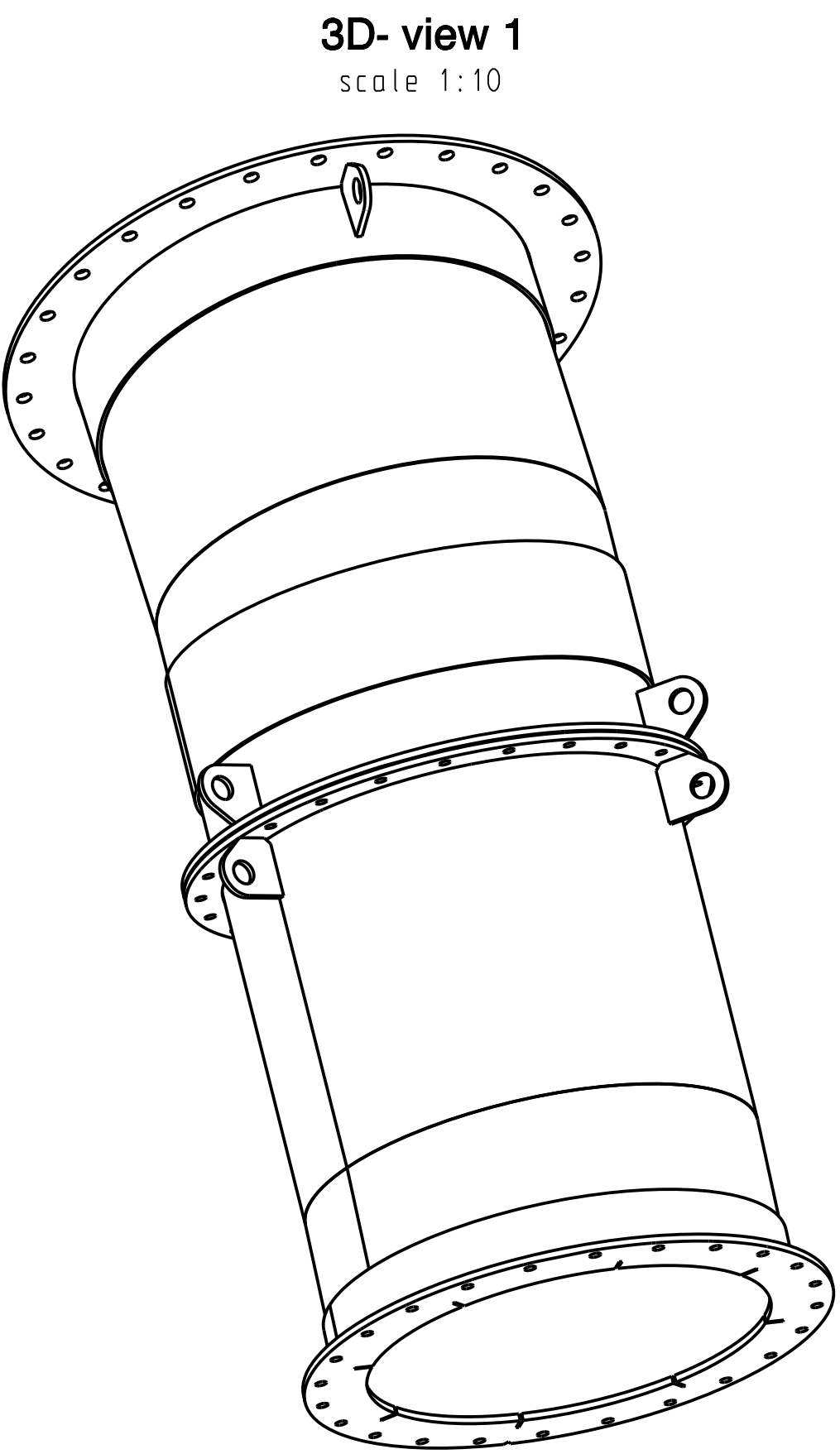
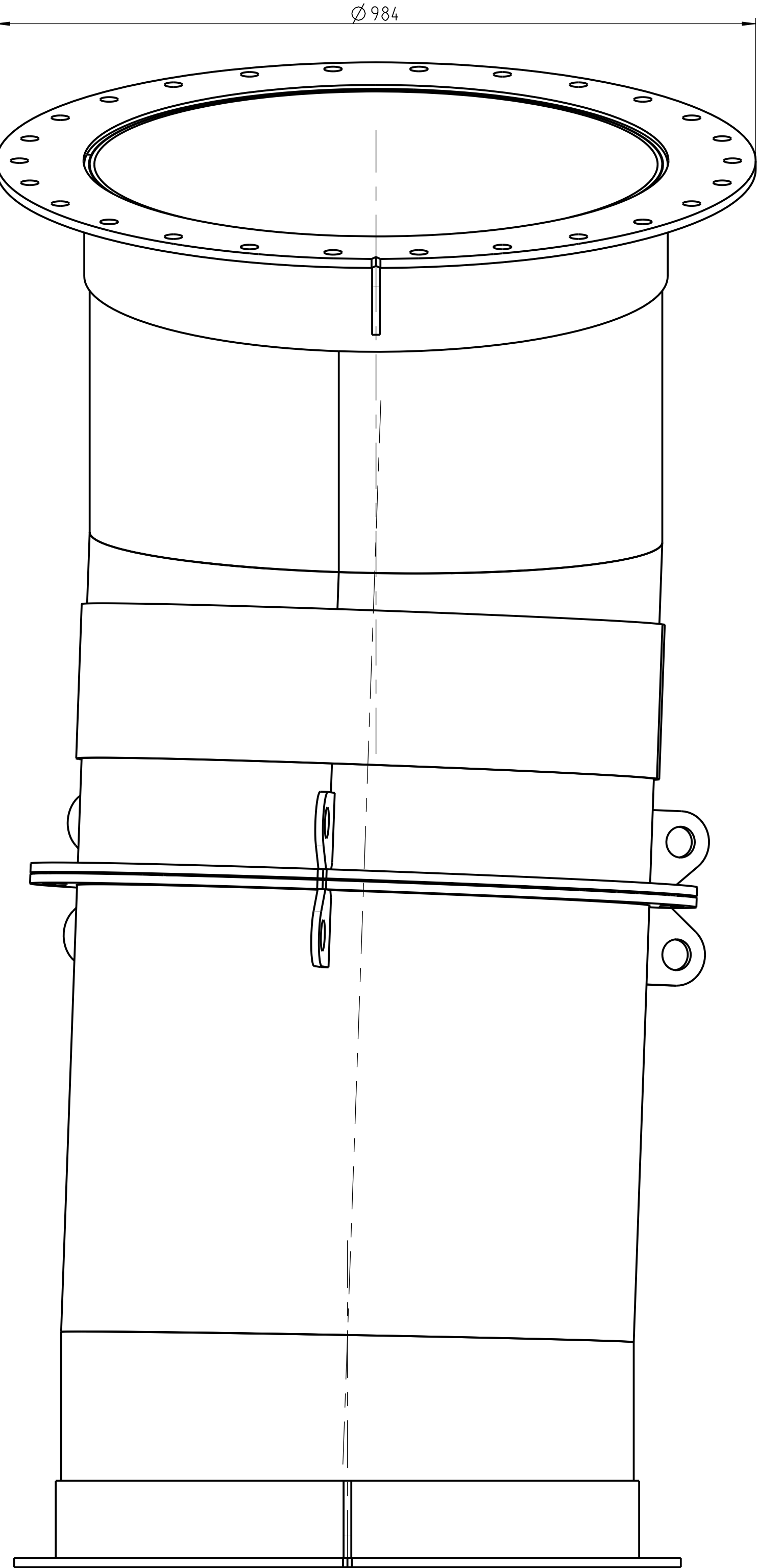
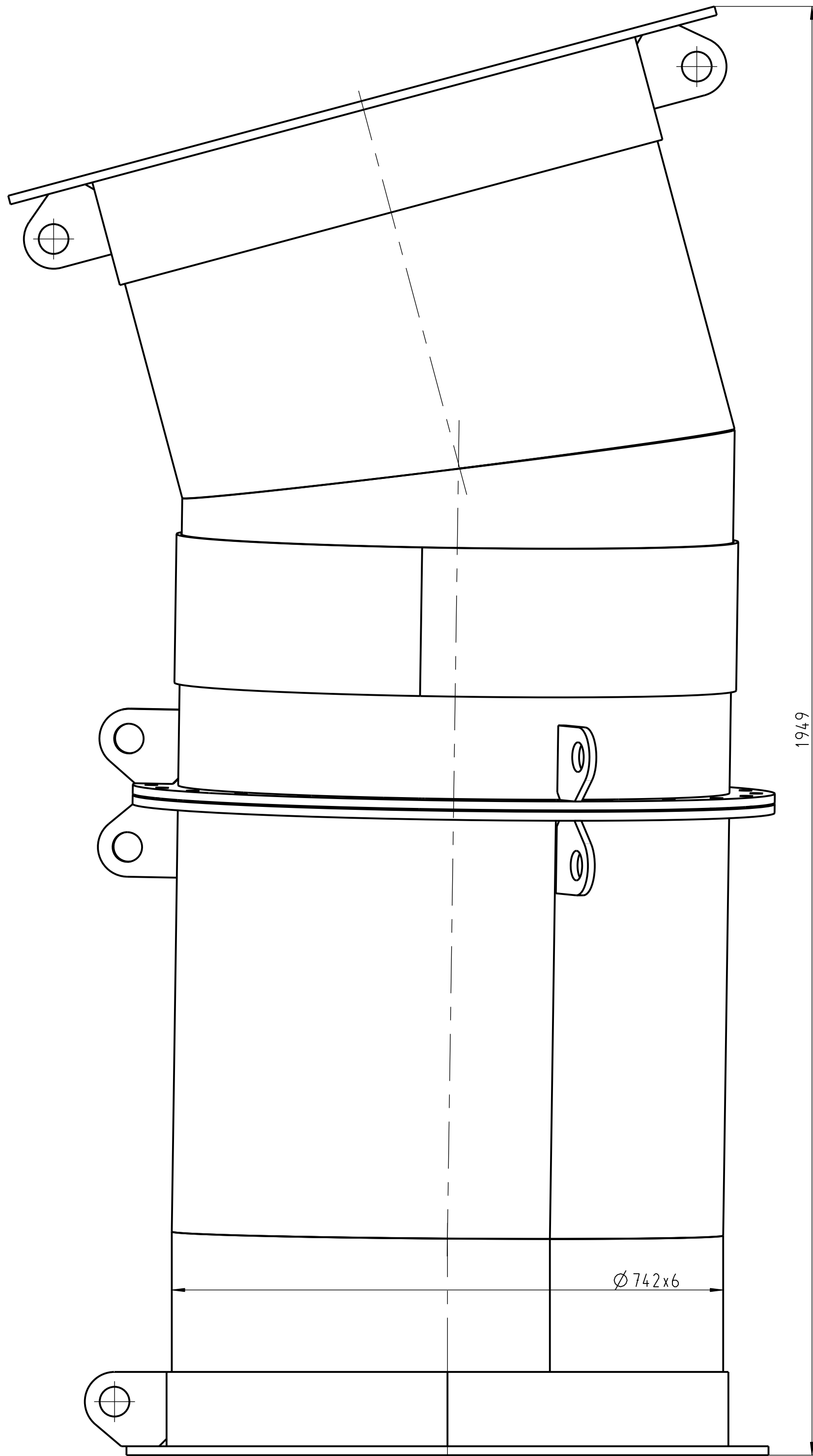

MANUFACTURING & INSTALLATION INSTRUCTIONS : (IF THERE ARE NO OTHER STATEMENTS)

- The welder must be certified according to EN 287 - part 1.
- Weld seam classification in accordance with EN ISO 5817 - table 1, assessment group C.
- All weld seams to be carried out in accordance with the instructions of the filler's manufacturer in respect to the properties of the base material.
- All weld seams to be carried out in full to the sheet metal thickness.
- All butt welds must be well-through.
- All flanges to be welded in place as the hole pattern shown on the drawing.
- All inside fold weld seams to be ground to a smooth transition to base metal.
- Undercuts to be avoided.
- Overall weld dimensional tolerances in accordance with EN ISO 13920.
- Table 1: tolerance class A, table 2: tolerance class B and table 3: tolerance class E.

The content of this drawing is our intellectual property. This drawing is only for personal usage given to the receiver. Without our written grant it is not allowed to duplicate or give it to a third party. An act contrary will be judicially prosecuted.

PM-Technologies GmbH

DESIGNED	DATE	NAME	PROJECT-Nr.
CHECKED	08.11.24	Nischelberger	P.CEO.011
PROJECTION	TITLE		
METHOD	mealchute 2		
AL DIMENSIONS IN MILLIMETERS (UNLESS NOTED)	stage 2		
SCALE	Cementownia Odra SA		
1:5	Poland		
WEIGHT	328kg	MATERIAL	1.0038
DRAWING No.		P.CEO.011/49-1300.00	



PM-Technologies GmbH
A-8200 Gleisdorf
Neugasse 111